



10 Ronaldsway

Crosby, Liverpool, L23 9XX

Offers in excess of £310,000



Available with ****NO VENDOR CHAIN DELAY****, this beautifully refurbished three-bedroom semi-detached home is situated in the highly sought-after and ever-popular residential area of Ronaldsway, Thornton. Renowned for its family-friendly atmosphere, the location enjoys excellent access to a range of local amenities including Aldi, Tesco Express, well-regarded schools and convenient transport links, making it an ideal purchase for families, first-time buyers and commuters alike.

Presented in excellent condition throughout and ready for immediate occupation, the property offers spacious and versatile accommodation. The ground floor briefly comprises a storm porch, welcoming entrance hallway with W.C., attractive bay-fronted lounge, rear sitting room with direct access onto the garden, and a stylish newly fitted kitchen which opens into a bright conservatory. A separate utility room provides additional practicality and offers access to the integral garage.

To the first floor are three well-proportioned bedrooms and a contemporary newly installed family bathroom.



Area Map

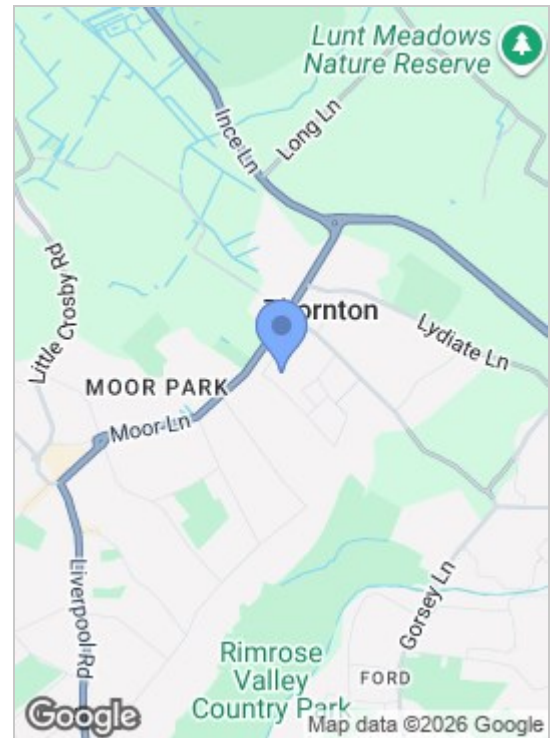

Floor Plans

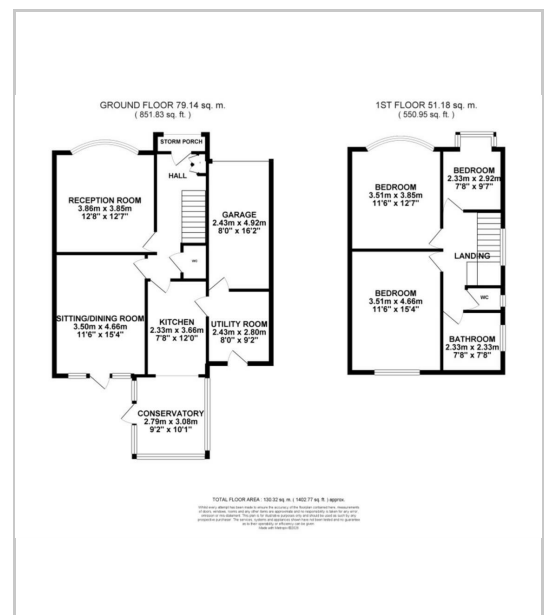

Energy Efficiency Graph

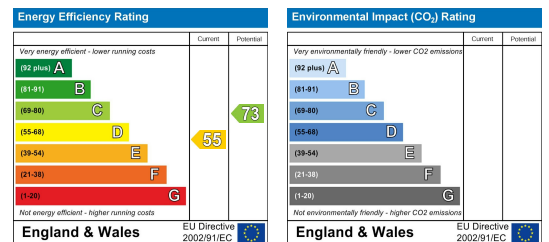

These particulars, whilst believed to be accurate are set out as a general outline only for guidance and do not constitute any part of an offer or contract. Intending purchasers should not rely on them as statements of representation of fact, but must satisfy themselves by inspection or otherwise as to their accuracy. No person in this firm's employment has the authority to make or give any representation or warranty in respect of the property.

82 Coronation Road, Crosby, Liverpool L23 5RH

Tel: 0151 909 3003
 Email: crosby@abode.group.co.uk
 Web: www.abode-group.co.uk

6 Allerton Road, Mossley Hill, Liverpool, L18 1LN

Tel: 0151 601 3003
 Email: allerton@abode-group.co.uk
 Web: www.abode-group.co.uk

2 Chapel Lane, Formby, Liverpool, L37 4DU

Tel: 01704 827 402
 Email: formby@abode-group.co.uk
 Web: www.abode-group.co.uk